

SAINT SPD Pedals PD-M821

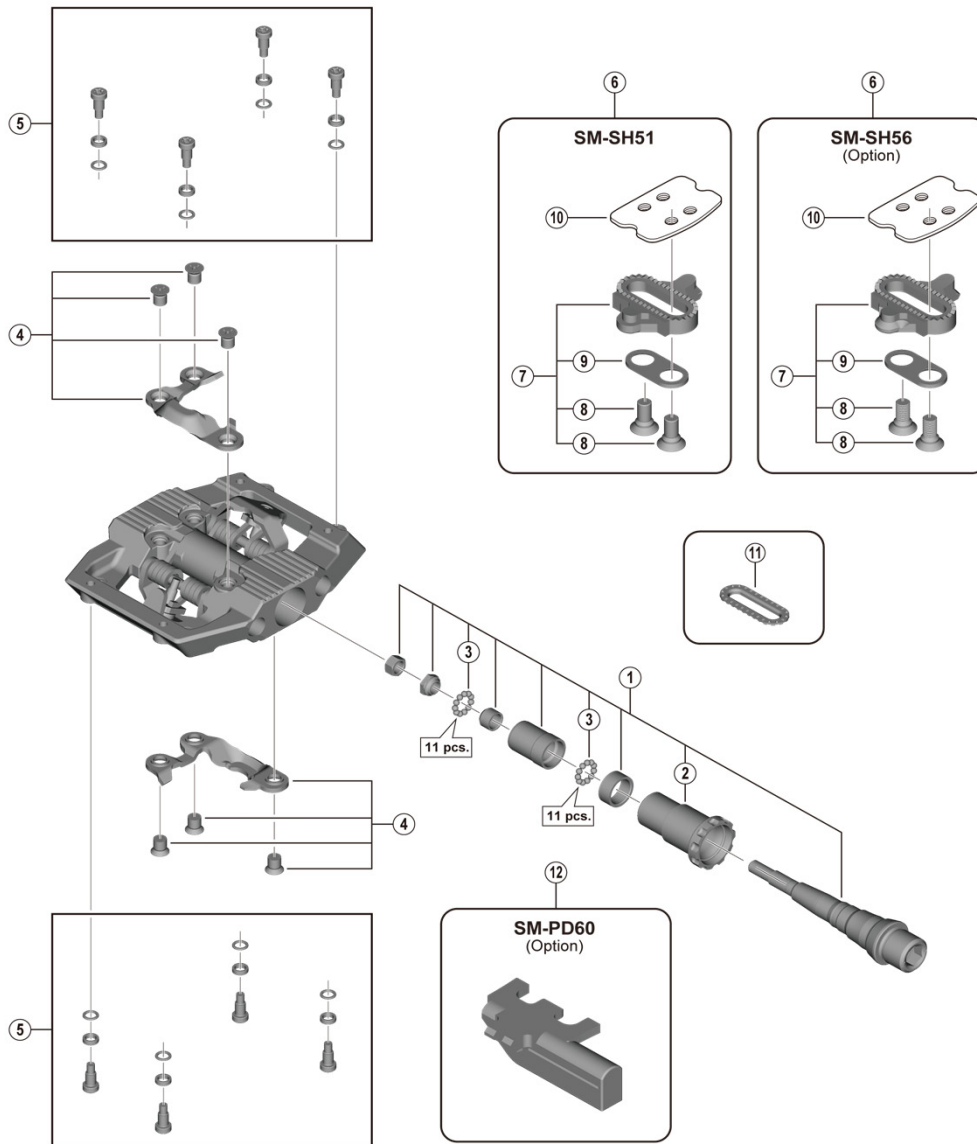

| ITEM NO. | SHIMANO CODE NO. | DESCRIPTION |
|----------|------------------|--|
| 1 | YL8U98010 | Pedal axle assembly (right / B.C.9/16" x 20T.P.I.) |
| | YL8U98020 | Pedal axle assembly (left / B.C.9/16" x 20T.P.I.) |
| 2 | YL8U98030 | Lock bush (right) |
| | YL8U98040 | Lock bush (left) |
| 3 | Y41N98030 | Steel ball (3/32") 62 pcs. |
| 4 | Y46K98030 | Body cover (right) and fixing screws (M5) |
| | Y46K98040 | Body cover (left) and fixing screws (M5) |
| 5 | YL8798010 | Pin and spacer (9 pcs.) |
| 6 | Y42498220 | SM-SH51 Cleat set (single release mode / pair) |
| | Y41S98092 | SM-SH56 Cleat set (multiple release mode / pair) |
| 7 | Y42498201 | SM-SH51 Cleat set without cleat nut (single release mode / pair) |
| | Y41S98100 | SM-SH56 Cleat set without cleat nut (multiple release mode / pair) |
| 8 | Y41704030 | Cleat fixing bolt (1 pc.) |
| 9 | Y42423000 | Cleat adapter (1 pc.) |
| 10 | YL0E04000 | Cleat nut (1 pc.) |
| 11 | YL8098030 | SPD Cleat spacer (2 pcs.) |
| 12 | Y40Z98010 | SM-PD60 Reflector unit standard/AS (pair/option) |

Mar.-2021-4729
© Shimano Inc. I

Specifications are subject to change without notice.

SHIMANO