

Cassette

**CS-LG700-11**

**CS-LG400-11**

**CS-LG300-10**

**CS-LG400-10**

**CS-LG400-9**

**CS-LG300-9**

**CS-LG700**

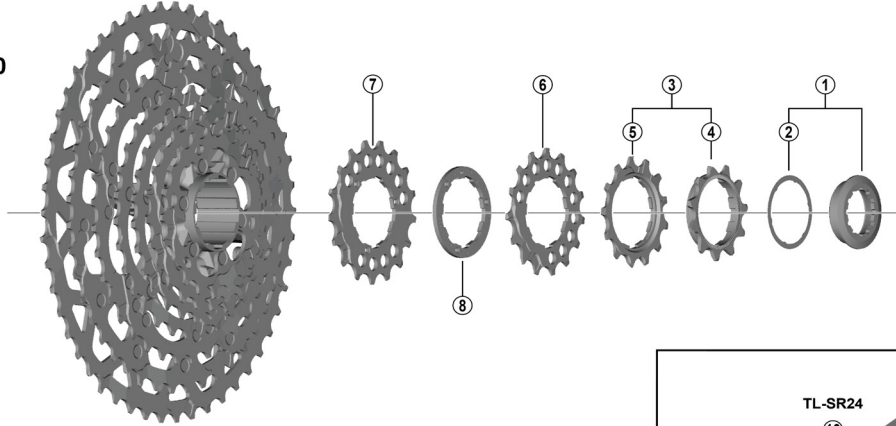

**CS-LG400  
CS-LG300**

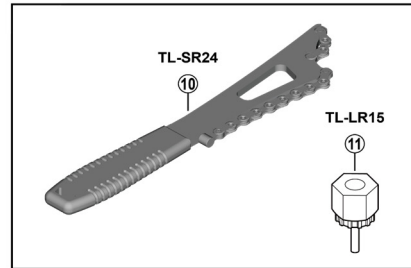
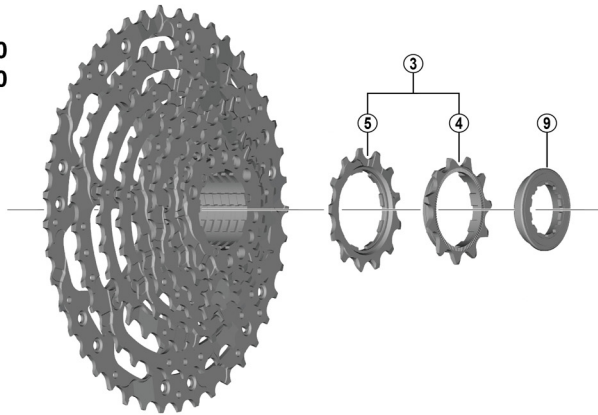

• Sprocket teeth combination

CS-LG700-11, LG400-11 (11-45T): 11-13-15-17-20-23-26-30-34-39-45T

CS-LG700-11, LG400-11 (11-50T): 11-13-15-17-20-23-26-30-36-43-50T

CS-LG400-10, LG300-10 (11-39T): 11-13-15-17-20-23-26-30-34-39T

CS-LG400-10 (11-43T): 11-13-15-17-20-23-26-30-36-43T

CS-LG400-10, LG300-10 (11-48T): 11-13-15-17-20-23-28-34-41-48T

CS-LG400-9, LG300-9 (11-36T): 11-13-15-17-20-23-26-30-36T

CS-LG400-9, LG300-9 (11-41T): 11-13-15-17-20-23-28-34-41T

CS-LG400-9, LG300-9 (11-46T): 11-13-15-17-20-23-28-36-46T

CS-LG700  
CS-LG600  
CS-LG400  
CS-LG300

ITEM NO.	SHIMANO CODE NO.	DESCRIPTION	INTERCHANGEABILITY			
			CS-LG700	CS-LG600	CS-LG400	CS-LG300
1	Y0RF98010	Lock ring and washer	A	B	B	B
2	Y10Z04000	Lock ring washer	A	A	B	B
3	Y0RF98020	Sprocket 11T and 13T for CS-LG700	A	B	B	B
	Y0RG98020	Sprocket 11T and 13T (used for CS-LG400)	B	B	A	B
4	Y0RF9801T	Sprocket 11T (built in spacer type) for CS-LG700	A	B	B	B
	Y0RG9801T	Sprocket 11T (built in spacer type) used for CS-LG400	B	B	A	B
5	Y0RF9802T	Sprocket 13T (built in spacer type) for CS-LG700	A	B	B	B
	Y0RG9802T	Sprocket 13T (built in spacer type) used for CS-LG400	B	B	A	B
6	Y0RF9803T	Sprocket 15T	A	B		
7	Y0RF9804T	Sprocket 17T	A			
8	Y0NC04000	Spacer A	A	A		
9	Y0RG98010	Lock ring (used for CS-LG400)	B	B	A	B
10	Y13098730	TL-SR24 Sprocket remover tool	A	A	A	A
11	Y12009230	TL-LR15 Lock ring removal tool	A	A	A	A

A: Same parts.

B: Parts are usable, but differ in materials, appearance, finish, size, etc.

Absence of mark indicates non-interchangeability.

Specifications are subject to change without notice.

Mar.-2023-4934

© Shimano Inc. I

**SHIMANO**